

THIS DOCUMENT IS THE PROPERTY OF SELECT CONTROLS INCORPORATED AND IS CONVEYED WITH THE EXPRESS CONDITION THAT IT AND THE INFORMATION CONTAINED IN IT ARE NOT TO BE USED, DISCLOSED, OR REPRODUCED IN WHOLE OR IN PART, FOR ANY PURPOSE WITHOUT THE EXPRESS WRITTEN CONSENT OF SELECT CONTROLS INCORPORATED; AND THAT NO RIGHT IS GRANTED TO DISCLOSE OR SO USE ANY INFORMATION CONTAINED IN SAID DOCUMENT.

NOTES:

1. SWITCH: PLANAR TILT, OMNIDIRECTIONAL, NORMALLY CLOSED, AUTOMATICALLY RESETTABLE
2. WEIGHT: 5 GRAMS MAXIMUM
3. CONTACTS: SPST, NORMALLY CLOSED
4. CONTACT RESISTANCE: 50 OHMS MAXIMUM
5. CONTACT RATING: 250 MA AT 24 VDC
6. INSULATION RESISTANCE: 30 MEGOHMS MINIMUM AT 500 VDC
7. OPERATING CHARACTERISTICS:
 - a) MUST OPEN WHEN TILTED PAST 25° +/-4° FROM VERTICAL POSITION
 - b) MUST RE-CLOSE WHEN RETURNING TO 21° FROM VERTICAL POSITION
8. OPERATING TEMPERATURE RANGE:
 - 65 DEGREES F TO +275 DEGREES F
9. SWITCH SEAL: HERMETIC
10. LEAD STRENGTH: 3 LBS. MINIMUM AXIAL PULL
11. OPERATIONAL LIFE: 1,000,000 CYCLES

5002-3-000

REVISIONS		
ALT	DESCRIPTION	BY
F	SEE ECN 5002-3-000F	AHN 10/18/12
		CHK
		ENG

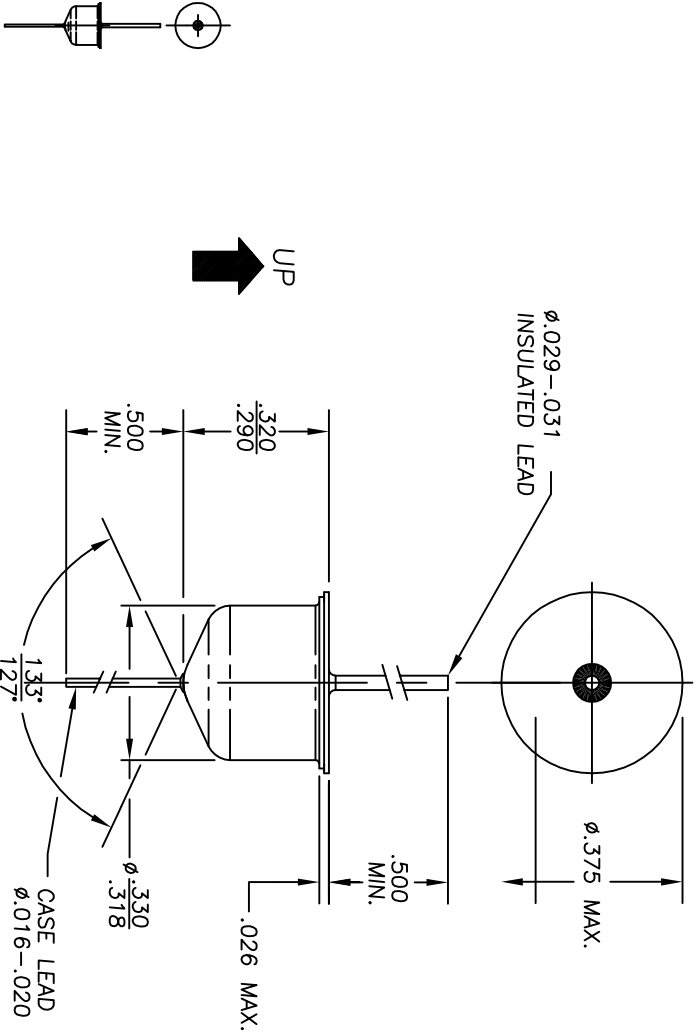

ACTUAL SIZE

MATERIAL	
FINISH	
DO NOT SCALE DRAWING DIMENSIONS TOLERANCE UNLESS SPECIFIED: FRACTIONS: 1/64 DECIMALS: .005 ANGLES: 30°	ANGLE: 30° DEC: .005 ANGLES: 30°

REV	DATE	DESCRIPTION	REMARKS
1	1/26/02	5002-3-000	

NO. REV'D	N/A	NO. REV'D	N/A	SCALE	4:1, 1:1	WEIGHT	NOTED	APPROVED	DATE	DRAWING NO.	REV.
										5002-3-000	F

TITLE		PART NO.		DESCRIPTION		REMARKS	
TILT SWITCH, 25° NORMALLY CLOSED				BILL OF MATERIAL			

SELECT CONTROLS INC.	45-3 KNICKERBOCKER AVE. BOHEMIA, N.Y. 11716
----------------------	--